



**BELLEVUE**  
ARCHITECTURAL

## New Products for 2021

**Bonaiti**

Magnetic Mortice Locks

Flush Pulls & Finger Pulls

Privacy Flush Pulls

Sliding Door Privacy Lock with Integrated Finger Pull

**CEAM**

BAC1431 3D Adjustable Concealed Hinge

**Justor**

BISA240 Heavy Duty Spring Hinge



+61 3 9571 5666



[www.bellevuearch.com.au](http://www.bellevuearch.com.au)



[info@bellevuearch.com.au](mailto:info@bellevuearch.com.au)



[instagram.com/  
bellevue\\_architectural](https://www.instagram.com/bellevue_architectural)







## Product Index

## Bonaiti

|                     |  |           |
|---------------------|--|-----------|
| <b>Introduction</b> |  | Pg. 4     |
| <b>BL060</b>        | - Externally rated Bonaiti magnetic cylinder locks | Pg. 5     |
| <b>BL062</b>        | - Externally rated Bonaiti magnetic privacy locks  | Pg. 5     |
| <b>BPFP60R/S</b>    | - Privacy flush pulls (round + square)             | Pg. 6 - 7 |
| <b>BL015T</b>       | - Sliding door lock with integrated finger pull    | Pg. 8     |
| <b>BFP4X</b>        | - Sliding door finger pull                         | Pg. 8     |
| <b>BFP60R/S</b>     | - Flush pulls (round + square)                     | Pg. 9     |
| <b>BFP3X</b>        | - Sliding door end pull                            | Pg. 9     |

## Didheya - Feature Product

|               |  |             |
|---------------|--|-------------|
| <b>K4500L</b> | - Sliding door privacy door flush pull kit with lock | Pg. 10 - 11 |
|---------------|--|-------------|

## CEAM

|                |   |             |
|----------------|---|-------------|
| <b>BAC1431</b> | - 3D Adjustable concealed hinge - max 175kg | Pg. 12 - 13 |
|----------------|---|-------------|

## Justor

|                |   |             |
|----------------|---|-------------|
| <b>BISA240</b> | - Heavy duty self-closing spring hinge - max 80/150kg | Pg. 14 - 15 |
|----------------|---|-------------|

## About Bonaiti

To talk about locks for wooden doors means first stepping back in time as far back as 1830 when Giuseppe & F.lli Bonaiti was founded in the small town of Lecco Italy, where area workshops produced the base metal used to create a series of components. The workshop gradually increased in size and manufactured fastenings, spring catches, bed warmers, chestnut roasting ovens, bed bases and the tubing used for headboards. In 1936, Bonaiti began to produce external application door locks.

At the beginning of the war he created a lock model fitted into the front of the door (an absolute novelty in those days) based on the British models patented at that time: hence the term "patented" which went on to become an everyday term to identify this type of lock.

The workshop (which over the years was gradually transformed into a production company with a staff of 500 to meet demand in the 1990s), gave rise to a spin-off business that became Bonaiti Serrature. All stages from design and production through to distribution in Italy and throughout the world were based here. The aim was to concentrate financial and human resources, developing the technologies to further develop these products. At the start of the 21st century, production of magnetic locks began - a culmination of all the research and development of recent years.

The company premises now cover a surface area of 17,000 square metres, with the various production units occupying 8,000 square metres of covered area, from the raw materials warehouse to the finished products warehouse whose 4,800 cubic metres store the 4,000 products to be distributed to 1,500 customers in Italy and the rest of the world. In the production departments, 71 staff produce 15,000 locks per day on 12 automated production lines that allow full control of operations and automatic packaging of every single product. It should be emphasised that all lock components use non-polluting materials and the production cycle is pollution-free, which has led to strong recognition of the company as ecocompatible.

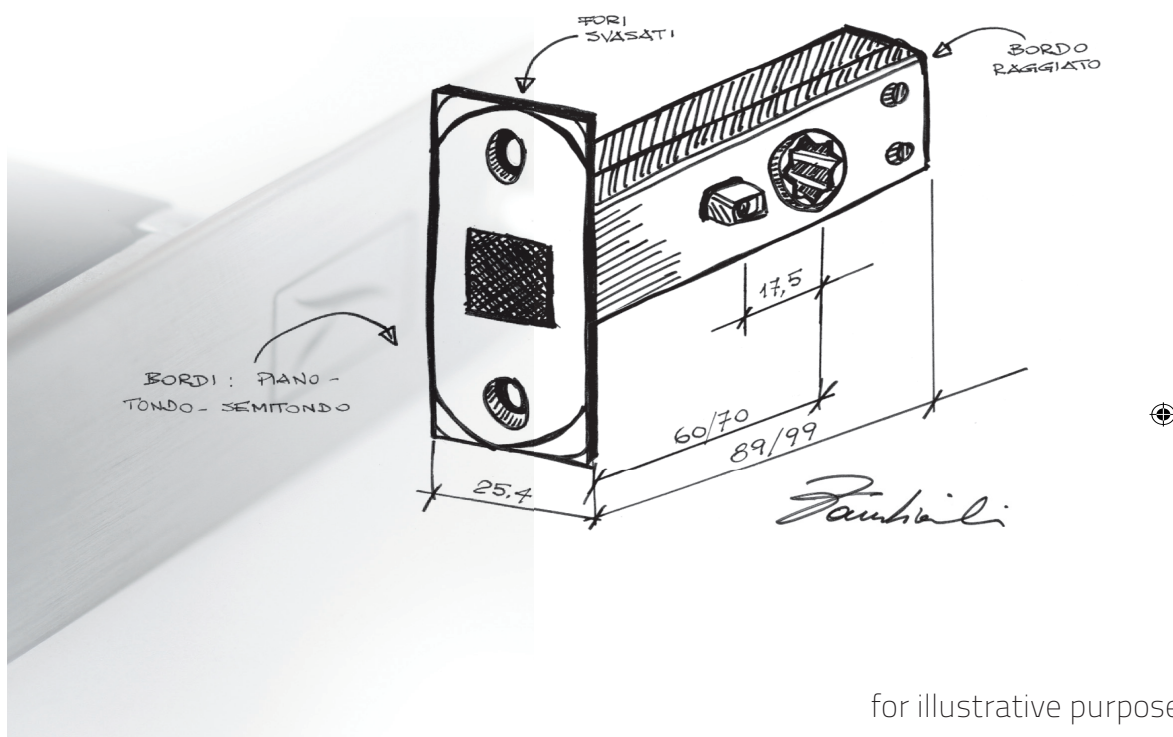

for illustrative purposes only



The Bonaiti BL060 & BL062 "*High Security Magnetic Mortice lock*" range is revolutionary due to the combination of magnetic and traditional locking/latching technology. No longer must we see and catch ourselves on a protruding latch tongue and striker plate (jamb side). The magnetic latch tongue is only extended once the door is in the closed position and the striker is only seen when the door is open.

By incorporating traditional locking technology, we can securely lock the door using the double throw steel dead bolt (BL060). The latching and locking mechanism are incorporated into the strong steel constructed body.

Specifically designed and manufactured to provide the highest levels of security for residential and commercial projects alike, the BL060 & BL062 are ideal for external and internal doors that require mid to high levels of security i.e. residential entry and perimeter doors, office and study doors etc. Extensively used throughout Europe, these locks have been warmly received in Australia and New Zealand with an extensive install base.

There is no visible striker plate when the door is closed. As a result you have a clean door & jamb. When the door is open, there is no unsightly latch tongue protruding from the edge of the door to catch your clothes on as they do not exist with the BL060 & BL062 – You achieve a clean look and feel.

There is now no longer any need for wide, custom made striker plates. The tongue only engages when the magnetism of both the latch and striker meet when the door is in the closed position.

Because the tongue engages due to the magnetic attraction to the cup in the striker plate on the jamb (and not due to moving and mechanical parts) there is significantly less that can go wrong during continuous or day to day operation. Tested to over 400,000 cycles.

Ideal for doors that would use a key lock. Capable of using all industry standard European cylinders. The BL060 is a 60mm back set mortice lock with the provision to cater for door hardware that uses normal tie through bolts.

Use the BL062 as a passage latch or privacy lock with a separate privacy turn and eRelease. Ideal for a WC type doors using a turn snib for privacy.

To open the door, all you do is pull the lever down as per any standard lock or latch. To unlock the door, use either the key or the turn snib.

The inbuilt heavy duty spring makes the BL060 & BL062 ideal for long term use with unsprung or poorly sprung lever sets. The heavy spring will ensure that handle does not droop over time and will always bounce back up.

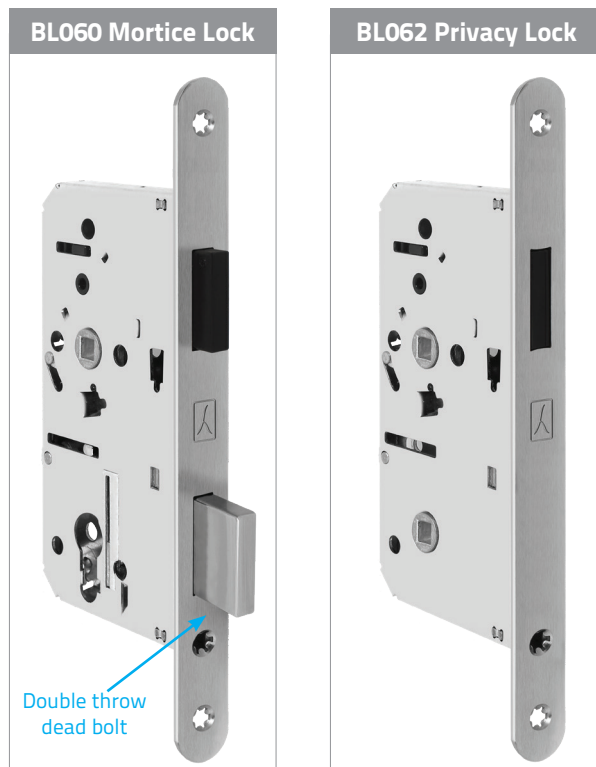

Technical drawing of a mechanical part showing three views: front, top, and side. The front view shows a rectangular part with a central circular feature and various dimensions. The top view shows the part's width and depth. The side view shows the part's profile. Dimensions are given in millimeters.

**Front View Dimensions:**

- Overall width: 82
- Overall height: 235
- Top flange width: 3
- Top flange height: 53
- Top flange thickness: 32
- Top flange offset: 60
- Top flange hole diameter:  $\varnothing 8.1$
- Top flange hole position: 19
- Top flange hole offset: 0
- Top flange hole diameter:  $\varnothing 8.1$
- Top flange hole position: 19
- Top flange hole offset: 46
- Top flange hole diameter:  $\varnothing 8.1$
- Top flange hole position: 8.1
- Top flange hole offset: 0
- Top flange hole diameter:  $\varnothing 8.1$
- Top flange hole position: 21.6
- Top flange hole offset: 1.65
- Top flange hole diameter:  $\varnothing 8$
- Top flange hole position: 80
- Top flange hole offset: 0
- Top flange hole diameter:  $\varnothing 8$
- Top flange hole position: 22.6
- Top flange hole offset: 35
- Top flange hole diameter:  $\varnothing 8$
- Top flange hole position: 45
- Top flange hole offset: 0
- Top flange hole diameter:  $\varnothing 8$
- Top flange hole position: 24
- Top flange hole offset: 0
- Top flange hole diameter:  $\varnothing 8$
- Top flange hole position: 14.5
- Top flange hole offset: 0

**Top View Dimensions:**

- Overall width: 24
- Overall height: 209
- Top flange width: 8
- Top flange height: 32
- Top flange thickness: 32
- Top flange offset: 60
- Top flange hole diameter:  $\varnothing 8.1$
- Top flange hole position: 19
- Top flange hole offset: 0
- Top flange hole diameter:  $\varnothing 8.1$
- Top flange hole position: 19
- Top flange hole offset: 46
- Top flange hole diameter:  $\varnothing 8.1$
- Top flange hole position: 8.1
- Top flange hole offset: 0
- Top flange hole diameter:  $\varnothing 8.1$
- Top flange hole position: 21.6
- Top flange hole offset: 1.65
- Top flange hole diameter:  $\varnothing 8$
- Top flange hole position: 80
- Top flange hole offset: 0
- Top flange hole diameter:  $\varnothing 8$
- Top flange hole position: 22.6
- Top flange hole offset: 35
- Top flange hole diameter:  $\varnothing 8$
- Top flange hole position: 45
- Top flange hole offset: 0
- Top flange hole diameter:  $\varnothing 8$
- Top flange hole position: 24
- Top flange hole offset: 0
- Top flange hole diameter:  $\varnothing 8$
- Top flange hole position: 14.5
- Top flange hole offset: 0

**Side View Dimensions:**

- Overall width: 24
- Overall height: 209
- Top flange width: 8
- Top flange height: 32
- Top flange thickness: 32
- Top flange offset: 60
- Top flange hole diameter:  $\varnothing 8.1$
- Top flange hole position: 19
- Top flange hole offset: 0
- Top flange hole diameter:  $\varnothing 8.1$
- Top flange hole position: 19
- Top flange hole offset: 46
- Top flange hole diameter:  $\varnothing 8.1$
- Top flange hole position: 8.1
- Top flange hole offset: 0
- Top flange hole diameter:  $\varnothing 8.1$
- Top flange hole position: 21.6
- Top flange hole offset: 1.65
- Top flange hole diameter:  $\varnothing 8$
- Top flange hole position: 80
- Top flange hole offset: 0
- Top flange hole diameter:  $\varnothing 8$
- Top flange hole position: 22.6
- Top flange hole offset: 35
- Top flange hole diameter:  $\varnothing 8$
- Top flange hole position: 45
- Top flange hole offset: 0
- Top flange hole diameter:  $\varnothing 8$
- Top flange hole position: 24
- Top flange hole offset: 0
- Top flange hole diameter:  $\varnothing 8$
- Top flange hole position: 14.5
- Top flange hole offset: 0

## Magnetic Lock Ordering Codes

BL060 (finish) - Magnetic cylinder lock 60mm back set  
BL062 (finish) - Magnetic privacy lock 60mm back set  
BL060REB (finish) - Rebate kit to suit BL060 & BL062 locks

SS = Satin Stainless PB = Polished Brass  
PS = Polished Stainless BLK = Matt Black BZ = Bronze by Request

| Quick Facts             |                               |
|-------------------------|-------------------------------|
| Compatibility           | Australian & NZ door hardware |
| Snib Compatibility      | Snibs using 6mm square bar    |
| Lock Hub                | 8mm (use solid 8mm spindle)   |
| Back Set                | 60mm                          |
| Double Throw Dead Bolt  | Yes (BL060)                   |
| Rated for External Use  | Yes                           |
| Visible Latch & Striker | No                            |
| Tongue Action Noise     | Silent                        |
| Rebate Kit Available    | Yes                           |
| Guarantee               | 2 years, 100% made in Italy   |

# BPFP60S | Privacy flush pull

Bonaiti of Italy

NEW

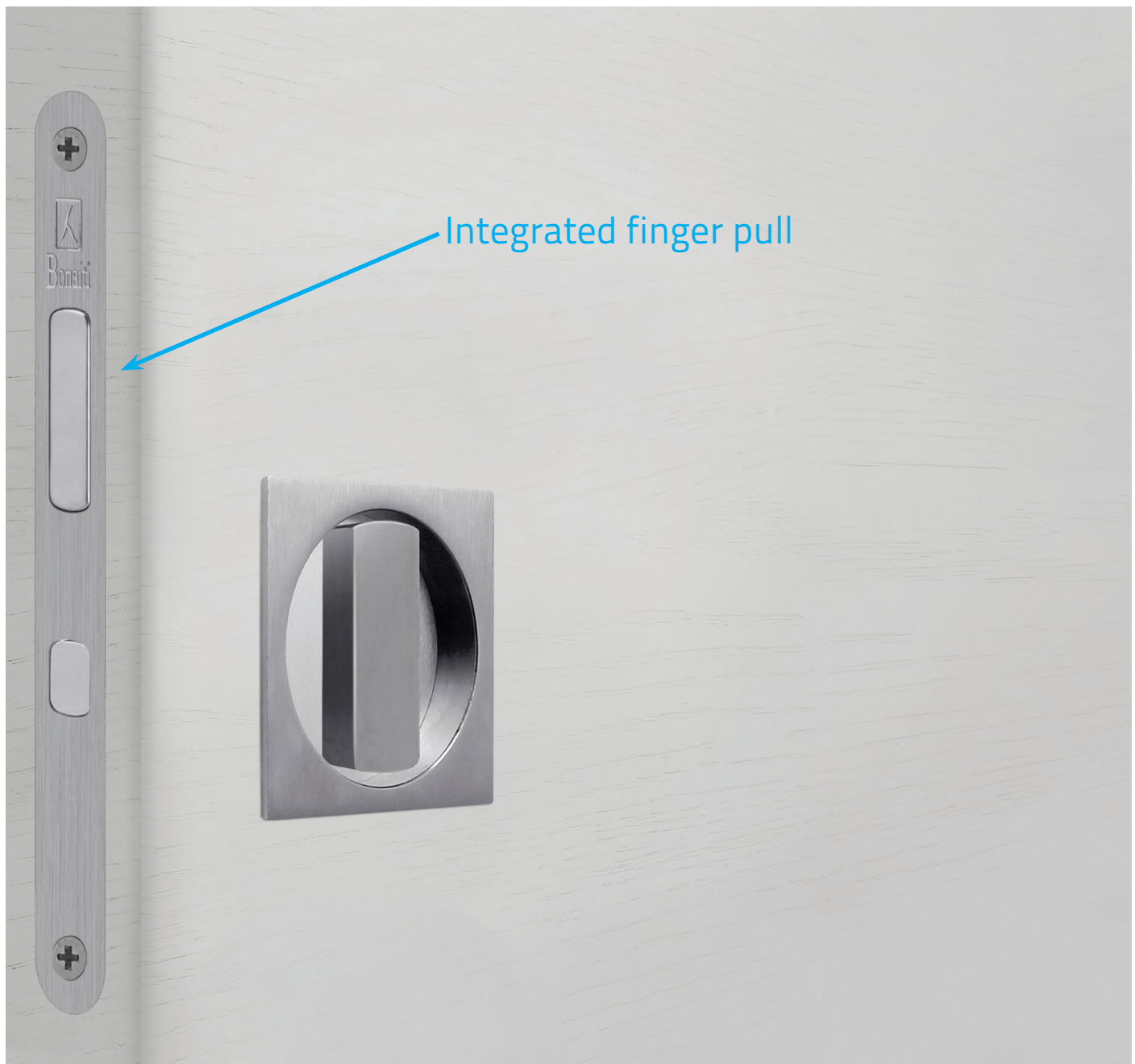

## Door Suitability:

Door thickness: 34mm (min) - 50mm (max)  
timber doors only

## Versions Available:

BPFP60ST - Privacy flush pull with BL015T sliding door lock  
BPFP60SL - Privacy flush pull with BL015 sliding door lock  
BPFP60S - Privacy flush pull only

## Available Finishes:

BZ = Bronze  
CR = Polished Chrome  
SC = Satin Chrome  
MB = Matt Black  
PB = Polished Brass  
SN = Satin Nickel

## Specification Codes:

BPFP60ST - Finish  
BPFP60SL - Finish  
BPFP60S - Finish

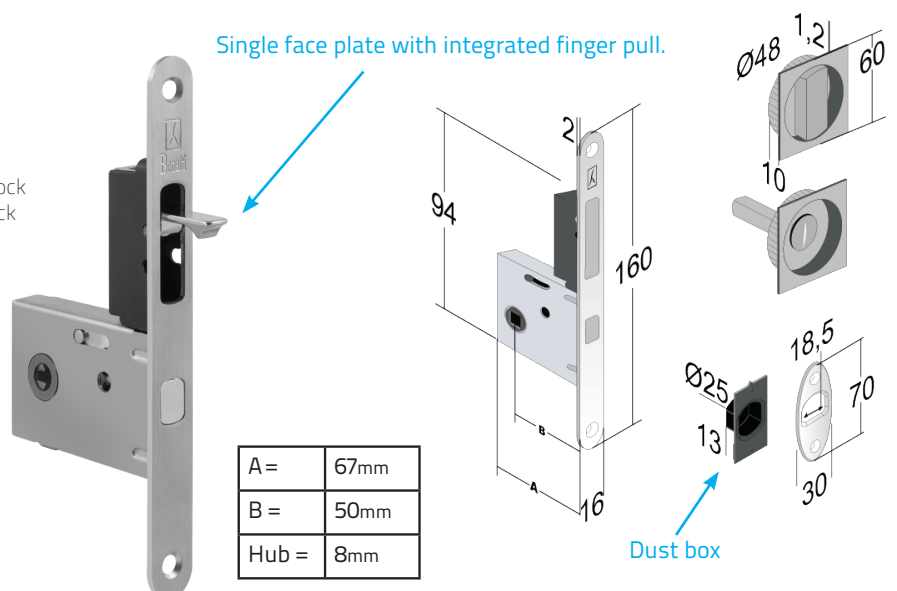





## BL015T | Sliding door lock with finger pull

Bonaiti of Italy

The BL015T combines a finger pull and lock system that would otherwise require two separate units. Suitable for both commercial and residential projects. The concealed locking mechanism doesn't detract from the flush finish of a cavity door.

### Clean and consistent

Thanks to the integrated finger pull, the BL015T allows a minimalist design on the door panel, it's more elegant with its flush front plate. The innovative finger pull allows an ergonomic and pleasant grip.

As an integrated unit the BL015T only requires one point of milling on the door edge.

### Secure latching every time

Bonaiti's legendary security is again featured in the BL015T with its smooth and precise movement always allowing the hooking of the striking plate. The hook latch grabs the inside of the striker cup holding the door firmly and securely in place.

### Match with a range of Bellevue privacy flush pulls

The BL015T is compatible with a wide variety of flush pulls using an 8mm square bar, including those stocked locally at Bellevue.

### Functionality

For fully recessed cavity sliding doors, the integrated flush finger pull allows easy retrieval from the cavity of the door.

### Reliability

Tested to over 400,000 cycles - totally reliable. With over 10 years of in market product experience built into every unit. Made 100% in Italy.

|       |      |
|-------|------|
| A =   | 67mm |
| B =   | 50mm |
| Hub = | 8mm  |

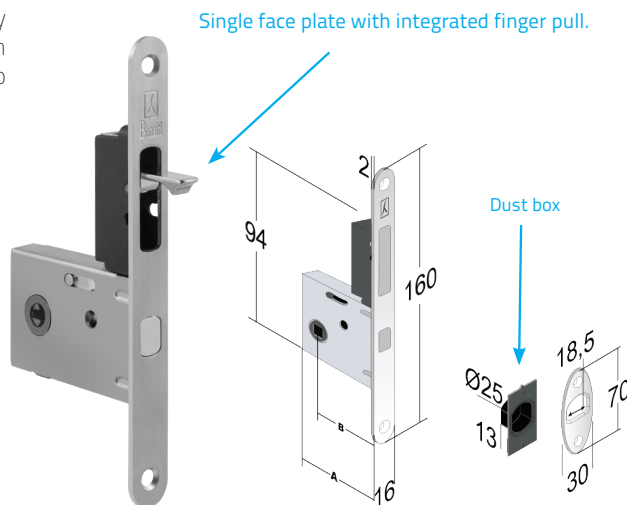

### Door Suitability:

Door Thickness: 34mm + timber doors only

### Available Finishes:

BZ = Bronze  
CR = Polished Chrome  
SC = Satin Chrome  
MB = Matt Black  
PB = Polished Brass  
SN = Satin Nickel

### Specification Codes:

BL015T - Finish

All measurements in mm

## BFP4X | Sliding door finger pull

Bonaiti of Italy

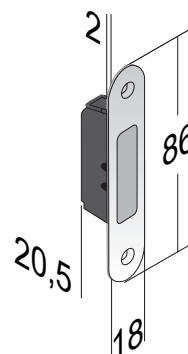

### Door Suitability:

timber doors

### Available Finishes:

BZ = Bronze  
CR = Polished Chrome  
SC = Satin Chrome  
MB = Matt Black  
PB = Polished Brass  
SN = Satin Nickel

### Specification Codes:

BFP4X - Finish

All measurements in mm



**Door Suitability:**  
timber doors

**Available Finishes:**  
BZ = Bronze  
CR = Polished Chrome  
SC = Satin Chrome  
MB = Matt Black  
PB = Polished Brass  
SN = Satin Nickel

**Specification Codes:**  
BFP60S - Finish

## BFP60S | Flush pull

Bonaiti of Italy

NEW

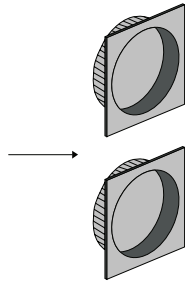
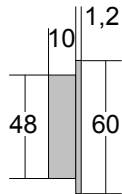

All measurements in mm

**Door Suitability:**  
timber doors

**Available Finishes:**  
BZ = Bronze  
CR = Polished Chrome  
SC = Satin Chrome  
MB = Matt Black  
PB = Polished Brass  
SN = Satin Nickel

**Specification Codes:**  
BFP60R - Finish

## BFP60R | Flush pull

Bonaiti of Italy

NEW

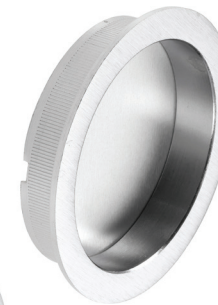
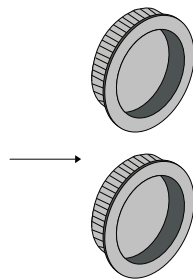
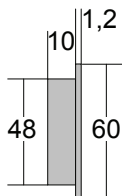

All measurements in mm

**Door Suitability:**  
timber doors

**Available Finishes:**  
BZ = Bronze  
CR = Polished Chrome  
SC = Satin Chrome  
MB = Matt Black  
PB = Polished Brass  
SN = Satin Nickel

**Specification Codes:**  
BFP3X - Finish

## BFP3X | Sliding door finger pull

Bonaiti of Italy

NEW

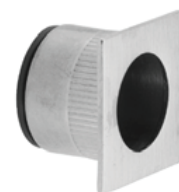
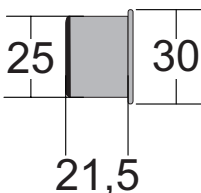

All measurements in mm

## K4500L | Sliding door privacy flush pull kit with lock

Didheya of Spain

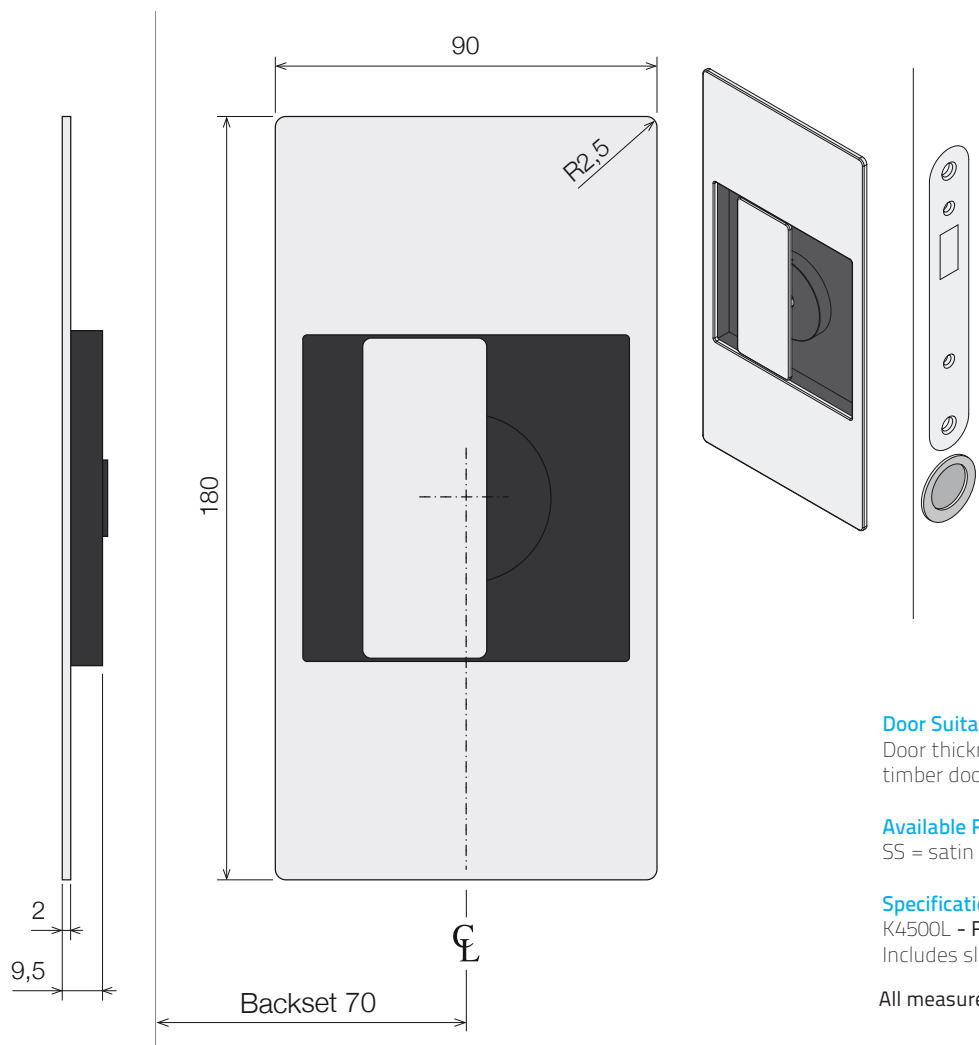

### Door Suitability:

Door thickness: 35mm +  
timber doors only

### Available Finishes:

SS = satin stainless steel

### Specification Codes:

K4500L - Finish

Includes sliding door latch

All measurements in mm







**K4500L Sliding door privacy flush pull lit with lock**

# 3D Concealed Hinge BAC1431 Technical Data

Fully Adjustable: Max 175kg CEAM of Italy



Expanded Range!

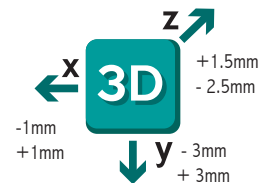

## Timber Rebate Measurements

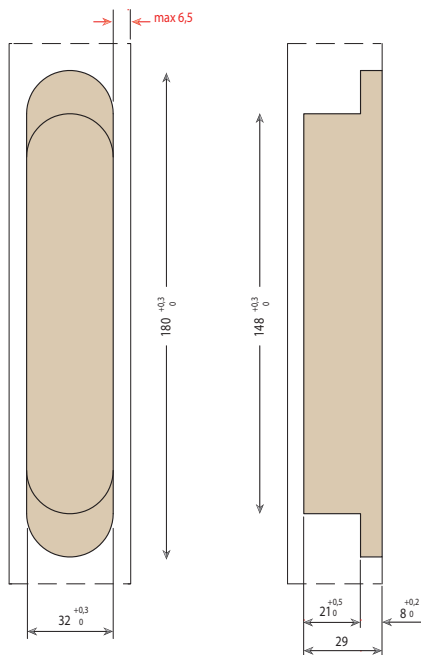

## Hinge Measurements

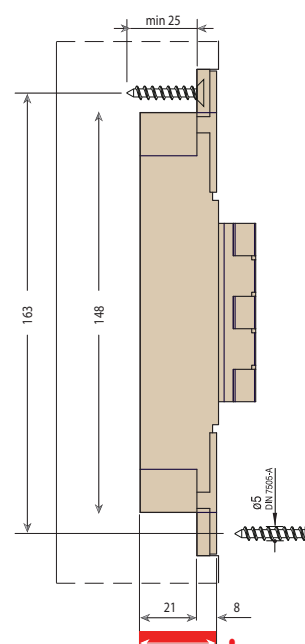
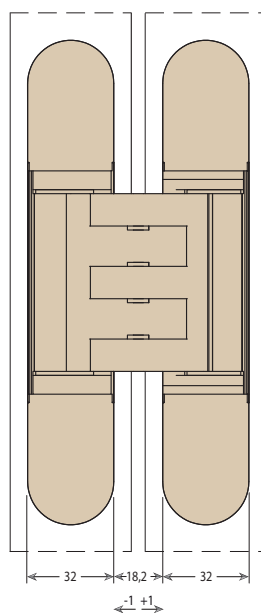

Only 29mm deep

## BAC1431 Diagrams

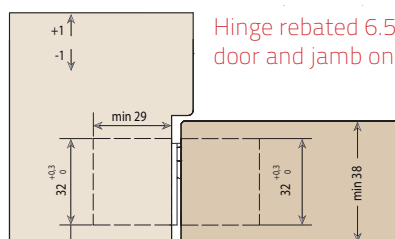

Hinge rebated 6.5mm max from edge of door and jamb on opening side

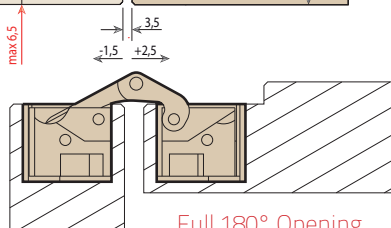

Full 180° Opening

## BAC1431 Quick Facts

- 3D adjustable
- CEAM quick release system
- Available in multiple finishes
- 100% Made in Italy for over 50 years
- Suitable for high frequency opening doors
- Jig & router template available for easy installation
- Suitable for internal & external (under cover) locations
- Suitable for residential, commercial & industrial locations

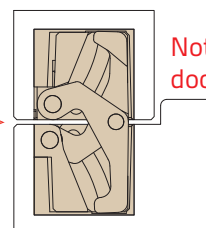
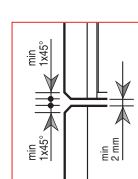

Note: if being used with a door closer see page 36.

Min 2mm gap between door and jamb

## No. of Hinges based on Door Width & Weight

For doors over 2100mm tall, see page 36

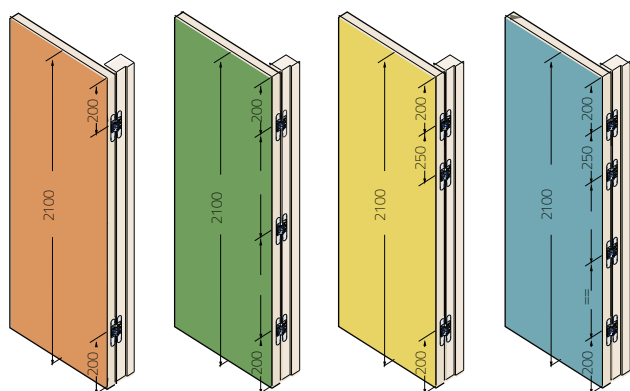

- 2 hinges per door
- 3 symmetrical hinges per door
- 3 asymmetrical hinges per door
- 4 hinges per door

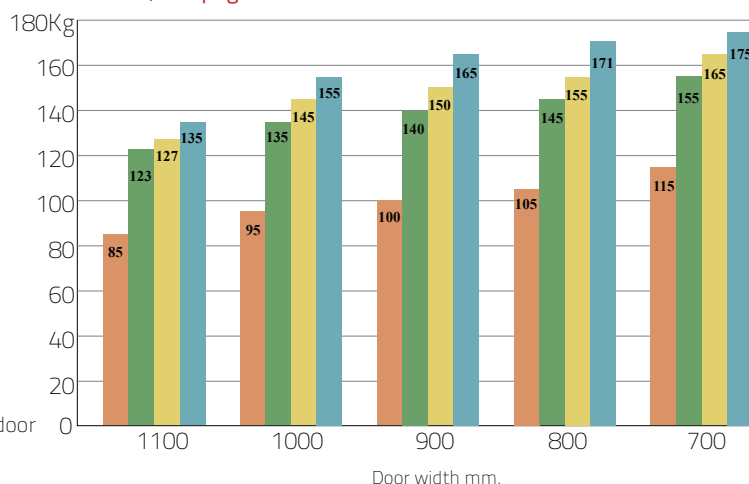

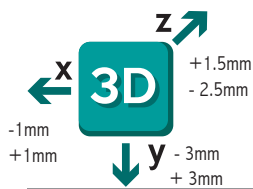

# 3D Concealed Hinge BAC1431 Functional Data

Expanded Range!

NEW

CEAM of Italy

Fully Adjustable: Max 175kg

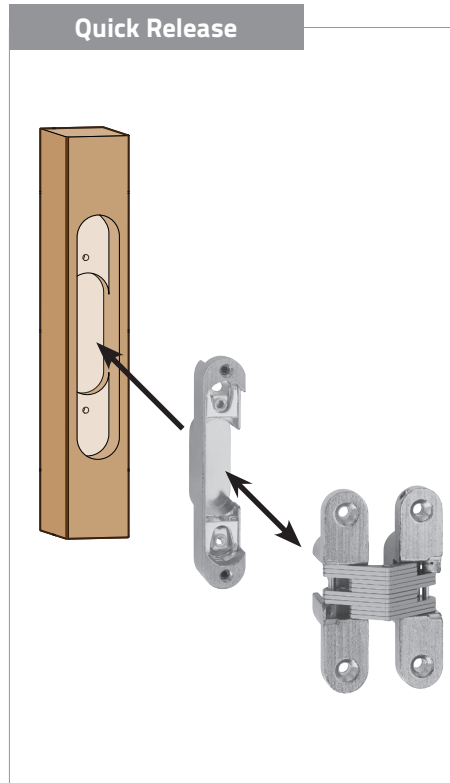

up to 175kg

The BAC1431 3D adjustable concealed hinge is revolutionary in its design and is rated to carry a 175kg door to 90° /180° opening aperture.

**A blended door to wall look and feel:** once closed, the BAC1431 hinge becomes invisible, hidden away by the jamb and the door butting up against each other.

Walls no longer need to be visually interrupted by the traditional butt hinge where the two leaves of the hinge meet and protrude out past the jamb.

The formal architectural composition of a wall can now continue without interruption, creating an aesthetically appealing appearance that is truly clean and elegant.

**NEW 3D fully adjustable Concealed Hinge for heavy doors up to 175Kg. Solid Colour Including the knuckle.**

**Quick release:** CEAM's quick release system is revolutionary - once the hinge is installed, you never need touch the door or jamb again.

The hinge sits within a cup, the cup is rebated and fixed to the door and jamb, the hinge is then fastened to the cup. As a result, if the door needs to come down, all you do is unscrew the locking bolts and remove the hinge from the cup.

The door can be removed and reinstalled for painting and adjustments without damaging timber or paint work, saving time and money.

**Door movement:** over time, this can be an expensive problem to fix. Not with the BAC1431 3D adjustable hinge; it specifically caters for door movement.

Once movement occurs, a door may not close properly or rub the paintwork. To fix, the door needs to come down and then the door and/or jamb needs to be planed and repainted; a costly and time consuming effort.

Using the BAC1431, simply adjust the position of the door via the settings within the hinge. This adjustment is done without the door coming down.

S.T.A.R.S.

## BAC1431 Quick Facts

|                        |   |
|------------------------|---|
| Min. door thickness    | 38mm  |
| Max. door weight       | 175kg- Subject to Width & Weight Chart                                |
| Narrow timber rebate   | 29mm (ideal for thin jambs)   |
| Gap when closed        | 2mm   |
| Working aperture       | 180°  |
| Manufacturing location | 100% Made in Italy  |
| Reliability            | Certified to over 150,000 cycles                                      |
| Adjustable             | 3D adjustment on 3 (X,Y,Z) axes                                       |
| Quick Release          | CEAM quick release system, never need to touch the door or jamb again |



## BAC1431 Order Codes

|                 |  |
|-----------------|--|
| BAC1431SI       | Silver                                       |
| BAC1431PB       | Polished Brass                               |
| BAC1431BL       | Black  |
| BAC1431WH       | White  |
| BAC1431BZ       | Bronze                                       |
| BAC1431SN       | Satin Nickel                                 |
| BAC1431CR       | Polished Chrome                              |
| BACJIG-BACT1431 | Jig & hinge template (rent or buy) pg. 37-39 |



# Spring Hinge BISA240 Technical Data

Zinc Plated 304 Grade Steel Justor of Spain



## Anatomy of a Single Action Spring Hinge:

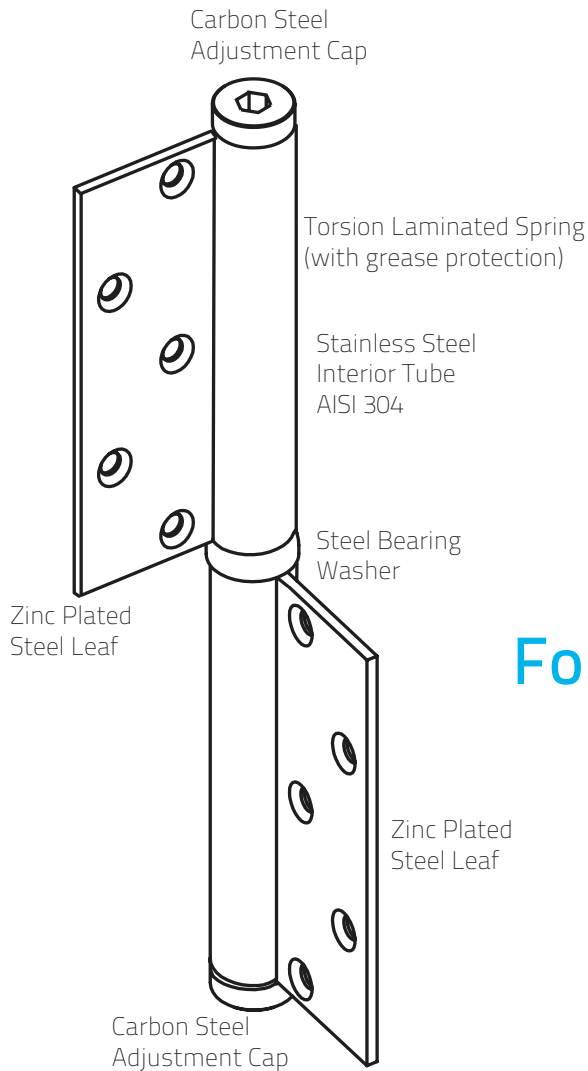

## BISA240 Adjustment Instructions:

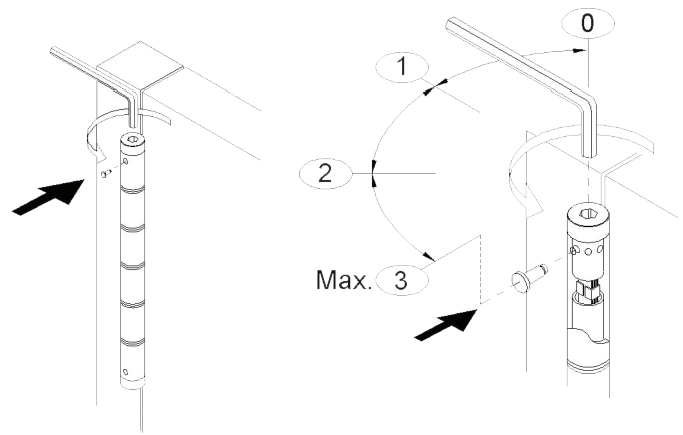

**New  
For 2021 !**

## Single Action Hinge Size and Dimensions:

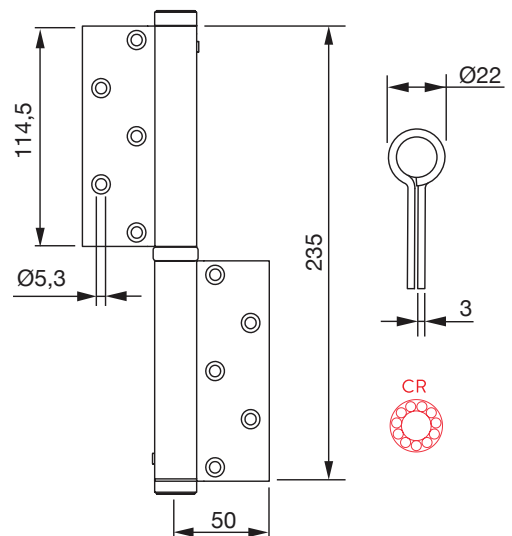

## Number of hinges required per door based on door weight & width:

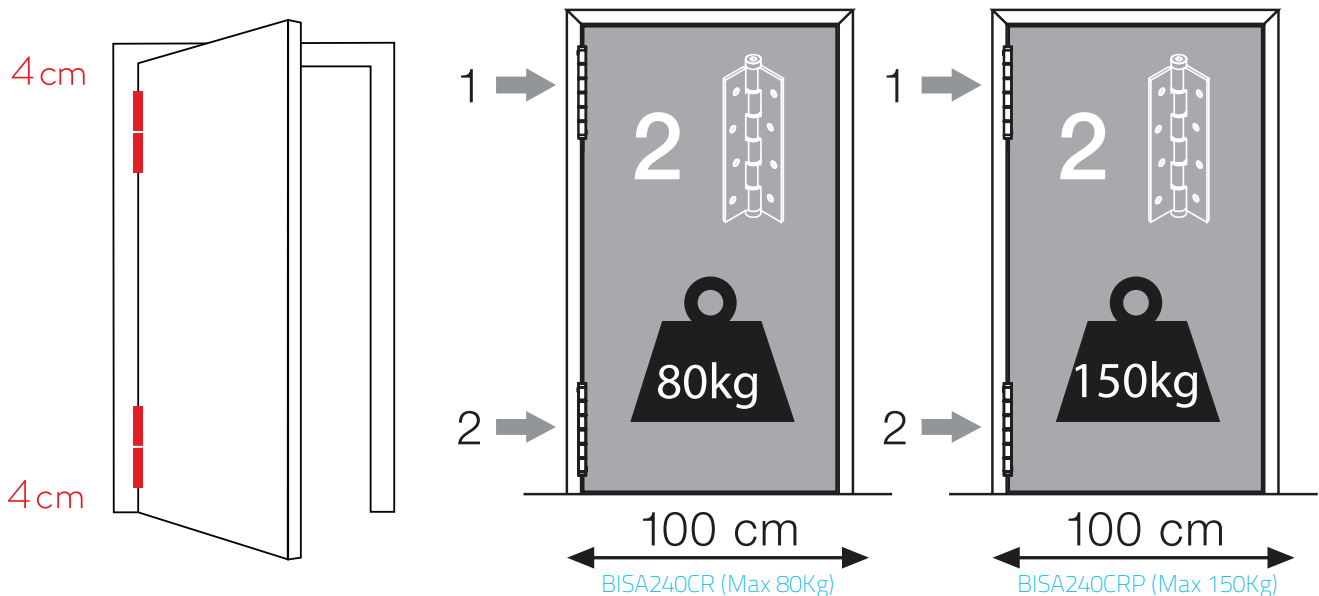



# Spring Hinge BISA240 Functional Data

Justor of Spain Zinc Plated 304 Grade Steel

Now there is no longer a need for unsightly door closers, the BISA240 family of single action spring hinges are designed to automatically close a door with a subtle visual appearance. Made in Spain by Justor, the BISA240 is highly functional and adjustable, ideal for all doors that weigh up to 150kg (refer to the weight graph).

Simplistically, the spring will act as a door closer and close the door once opened. Made out of Zinc Plated Steel, the BISA240 single action spring hinge is ideal for internal or external applications. Once installed the BISA240 spring hinge can be adjusted to bring the door back quickly or slowly via three (3) tension settings. Each setting provides detailed control of the door closure speed. Adjustments can be made without having to take the door down.

Currently the BISA240 spring hinge is being used on perimeter doors, pool doors, gates, front doors, large feature doors, office doors & WC doors, just to name a few. The BISA240 has been installed in restaurants, hospitals, commercial buildings, apartments, boats, residential environments and general projects of all sizes throughout Australia and New Zealand.

An added advantage of the BISA240 is its appearance; it is sleek and has clean lines. Cost effective and highly functional, it is a real and effective alternative to traditional and unsightly door closers and closing solutions. Justor BISA240 spring hinge comes with a 2 year manufacturer's Guarantee; the Justor BISA240 is hard to overlook.

The BISA240 is a maintenance free solution; no periodic greasing or adjustments required, just 1 drop of oil in the top cap once a year - a smart design. The BISA240 represents a smarter option when it comes to design and aesthetics.

## BISA240 Quick Facts:

- Spring Resistance 500,000 cycles
- Zinc Plated Steel
- Resistant to Extreme Climatic Conditions (Cold and Humidity)
- Maximum resistance to bending
- BISA240CRP | Up to 150kg in Door Weight
- BISA240CR | Up to 80kg in Door Weight
- Torsion Spring not a Coil Spring
- Variable Closing Strength (speed)
- 90° or 180° Working Aperture
- For Wood or Aluminium Doors
- Slim Profile vs. Bulky Door Closer
- Quick & Simple Installation
- Manufactured in Spain and comes with a 2 Year Manufacturer's Guarantee

## Where the BISA240 is being used

- Residential Environments
- Apartment Buildings
- Hotels of All Sizes
- Commercial Environments
- Industrial Estates
- Restaurant Kitchens
- Hospitals
- Retail Market

## Order Codes:

Base Material: Zinc

- BISA240CRP (Max 150Kg)
- BISA240CR (Max 80Kg)

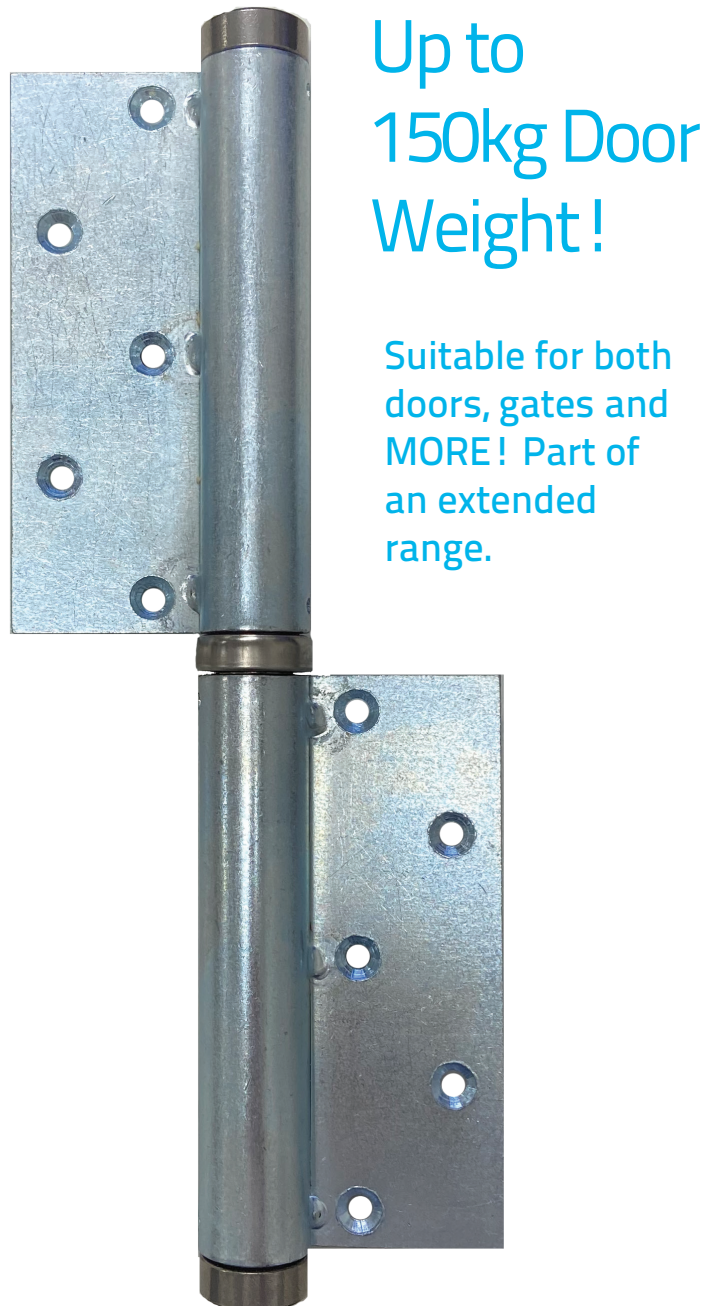

Up to  
150kg Door  
Weight!

Suitable for both  
doors, gates and  
MORE! Part of  
an extended  
range.



CEAM concealed hinges by Bellevue Architectural

**Bellevue Architectural**  
954 Glen Huntly Road  
Caulfield South Vic 3162

PH: (03) 9571 5666  
[Info@bellevuearch.com.au](mailto:Info@bellevuearch.com.au)  
[www.bellevuearch.com.au](http://www.bellevuearch.com.au)

\*Please note that all images in this document are used for illustrative purposes only.  
Product specifications are subject to change without notice.

New Products for 2021: Catalogue 2/21