

BIPG240 updated to carry 250Kg

BIPGCR welding spring hinge

For welding onto steel jambs and frames

Bellevue is proud to introduce the Justor spring hinge range of welding hinges designed to automatically close light to heavy steel framed doors and metal gates that weigh up to **250kg**. The Justor BIPG120, BIPG180CR, BIPG240CR welding spring hinges are sleek, stylish and simple. Made in Spain by Justor to exacting European standards, these models are adjustable torsion based spring hinges.

Due to its unique construction, the BIPG range, made of steel is fully adjustable while the door is still hanging. The BIPG range can be used on internal or external steel or metal-framed door jambs, gates and doors - whenever a gate/ door needs to close without assistance. Made in Spain By Justor, the BIPG range of welding hinges represent quality and innovation not normally seen in a product of this type. Optionally, the BIPG range can be powder coated or painted. Once done, it blends into any environment and surroundings.

Cost effective and highly functional, it is a real and effective alternative to traditional unsightly door closers and closing solutions. The BIPGCR range is a maintenance free solution - no periodic greasing or adjustments required, just 1 drop of oil in the top caps once a year. The BIPGCR spring hinge comes with a 2 year manufacturer's Guarantee.

Anatomy of a spring hinge:

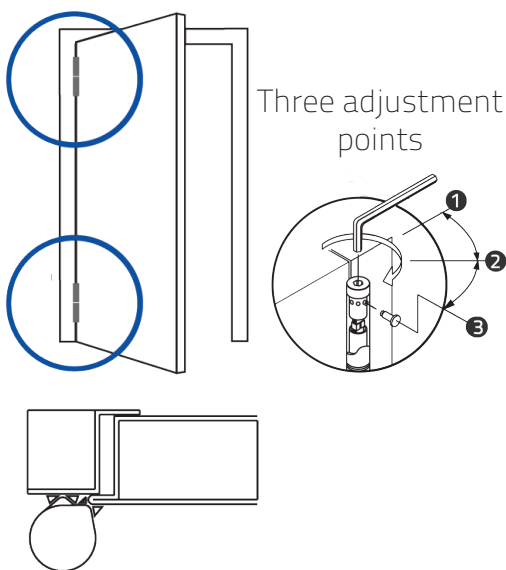
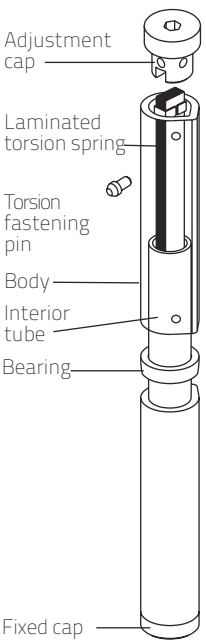

Technical data

For welding

Dimension & weight info:

BIPG120

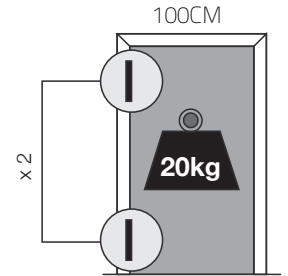
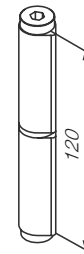
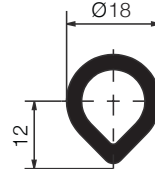

BIPG180CR

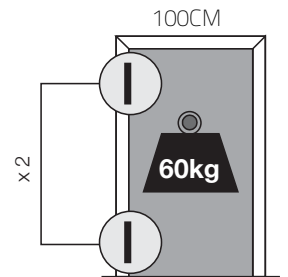
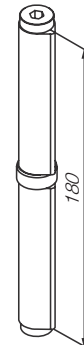
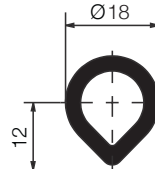

BIPG240CRP

Updated to carry 250Kg

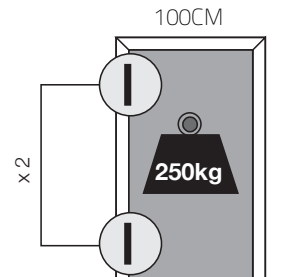
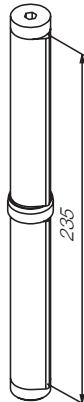
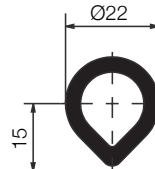

BIPG quick facts:

- Spring resistance 500,000 cycles
- Used in place of existing hinges
- Multiple sizes for different weights
- Up to 250kg in door weight
- Torsion spring not a coil spring
- Variable closing strength
- 90° or 180° working aperture
- Solid and stylish design
- For metal doors, gates and frames
- Ideal for internal or external use
- Slim profile
- 2 Year manufacturer's guarantee
- Made in Spain

Order codes:

- | | |
|-----------------------|------------------------|
| ▪ BIPG120 - 20kg | ▪ BIPGN120 - 20kg |
| ▪ BIPG180CR - 60kg | ▪ BIPGN180CR - 60kg |
| ▪ BIPG240CRP - 250 kg | ▪ BIPGN240CRP - 250 kg |

Finish: Gun metal is a raw finish which can be powder coated or painted to specific colours.